

# MEASURE S UPDATE

**GLENDALE UNIFIED SCHOOL DISTRICT  
Board of Education Meeting – May 1, 2012  
Discussion Report No. 1**



**EVA RAE LUECK  
CHIEF BUSINESS AND FINANCIAL OFFICER**

# Superintendent's Facility Advisory Committee (SFAC)

- Meeting held Monday, April 23, 2012
- Technology Update
- Functional Assessment – Supported
- Clark Electrical Upgrade - Supported
- Portable Classroom Buildings at Administration for Daily - Supported
- Measure S Update
- Next Meeting – Monday, May 7, 2012

# Citizens' Bond Oversight Committee (CBOC)

- Meeting held Monday, April 30, 2012
- Review Draft Accounting and Reporting Documents
- Next Meeting – TBD



May 1, 2012

# Initial Bond Priorities & the Order they will be Discussed at Future Board Meetings

1. **Security & Safety** (Discussed on March 20)
2. **Instructional Programs** (Discussed on April 3)
3. **Cafeteria, Auditorium & Athletic Facilities Renovations** (Discussed on April 17)
4. **Technology** (Tonight)
5. **Functional Assessments – District Admin., Daily, PDC, PAEC, FASO**



May 1, 2012

# Tonight's Agenda

## Project Authorization No. 19 with Osborn Architects for Clark Electrical Upgrade

- Extend 400-amp Service to the 6000 Building in the Form of Two, 200-amp Panels. The Conduit Run will be Primarily Surface Mounted on the Building
- Provide New Power Outlets in the Robotics Lab on an Isolated Circuit
- Adjust the Existing Electrical Outlets as Required to Accommodate the New Outlets and to Achieve ADA Compliance



- Total Project Cost Including Soft Costs - \$514,286

# Tonight's Agenda

## Project Authorization No. 20 with KPI Architects for the Placement of 2 Portable Classroom Buildings at Administration for Daily

- Total Project Cost \$166,862

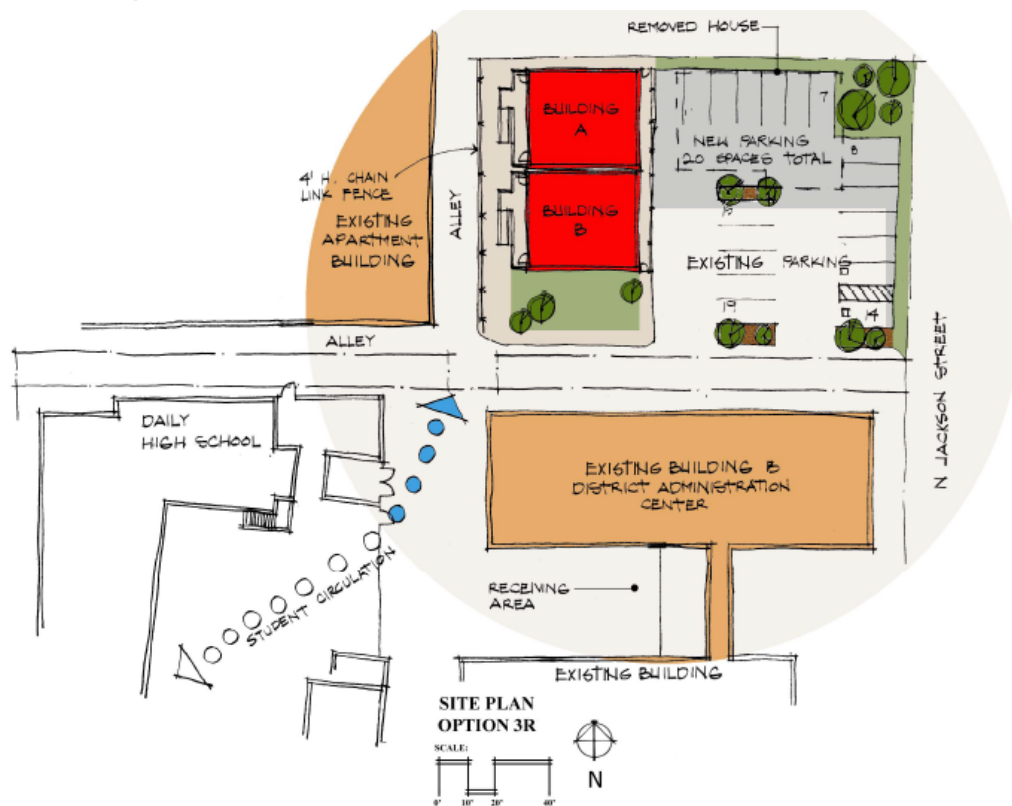

**GLENDALE UNIFIED SCHOOL DISTRICT**  
**DAILY HIGH SCHOOL**  
**RELOCATABLE CLASSROOMS**

REVISED APRIL 23, 2012  
APRIL 18, 2012



May 1, 2012

# Tonight's Agenda

## Approval of Agreement with IBI Group for Functional Assessments

### Programmatic Assessment of Ancillary Sites with IBI Group

- Administration Building
  - Daily High
  - Professional Development Center
  - Pacific Avenue Educational Center
  - Facility and Support Operations
  - Planning and Development
- 
- Total Fee is \$79,432



May 1, 2012

# Future Agenda Items

- CREBS – Solar
- Solar Amendment
- College View Schedule
- Work Study - Prioritization